

Wiegand Output To Relay Dry Point

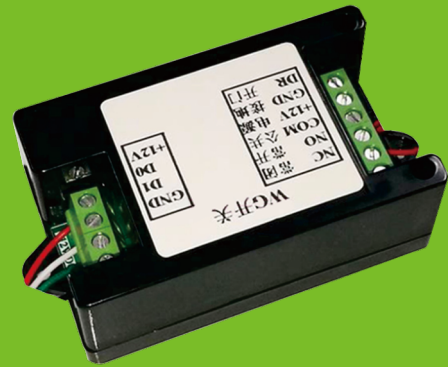

WIEGAND-DRY

Specifications

Size	88X50X31mm (including installation hole 96.5X50X31mm)
Voltage and current	9~15V100mA
Relay maximum load	AC250V10A, DC30V10A
Relay delay	minimum 1 second, maximum 60 seconds
Wiegand interface format	WG26~WG80

Wiring Diagram

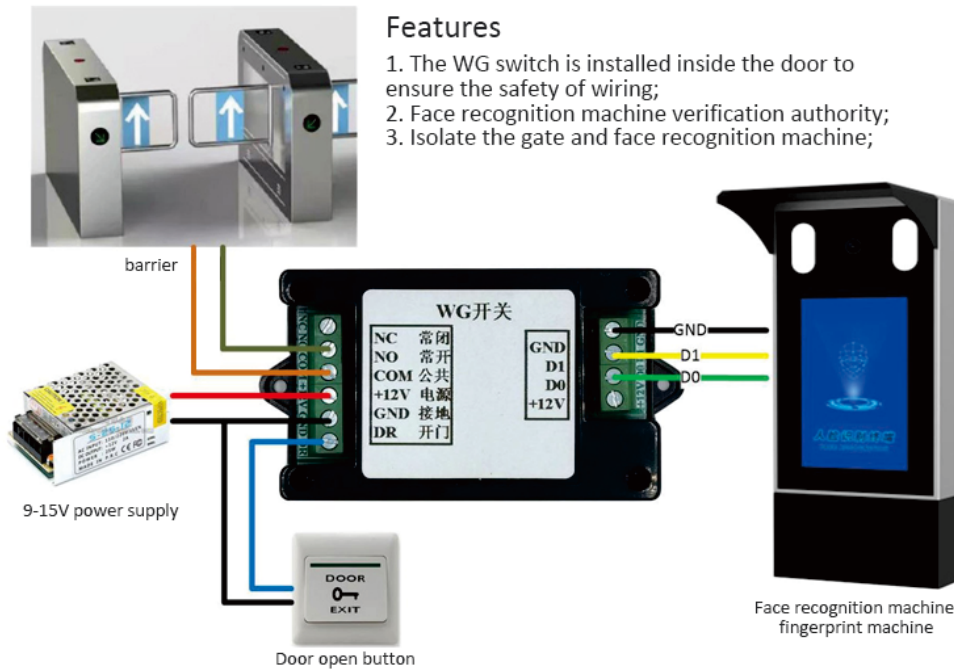

Features

1. The WG switch is installed inside the door to ensure the safety of wiring;
2. Face recognition machine verification authority;
3. Isolate the gate and face recognition machine;